

Note - I send this copy forward to prevent disappointment in obtaining a patent, in case a former Return has not been made, or Miscarried the reason of inverting Mayor June is - the Copy in my hands says Ma in its proper place - And is endorsed June - which error you will be able to correct - the excess of quantity in those days was generally overlooked - considered as not injurious to the State But should you consider it as acceptable please to direct

Andrew Porter Esquire  
Surveyor General

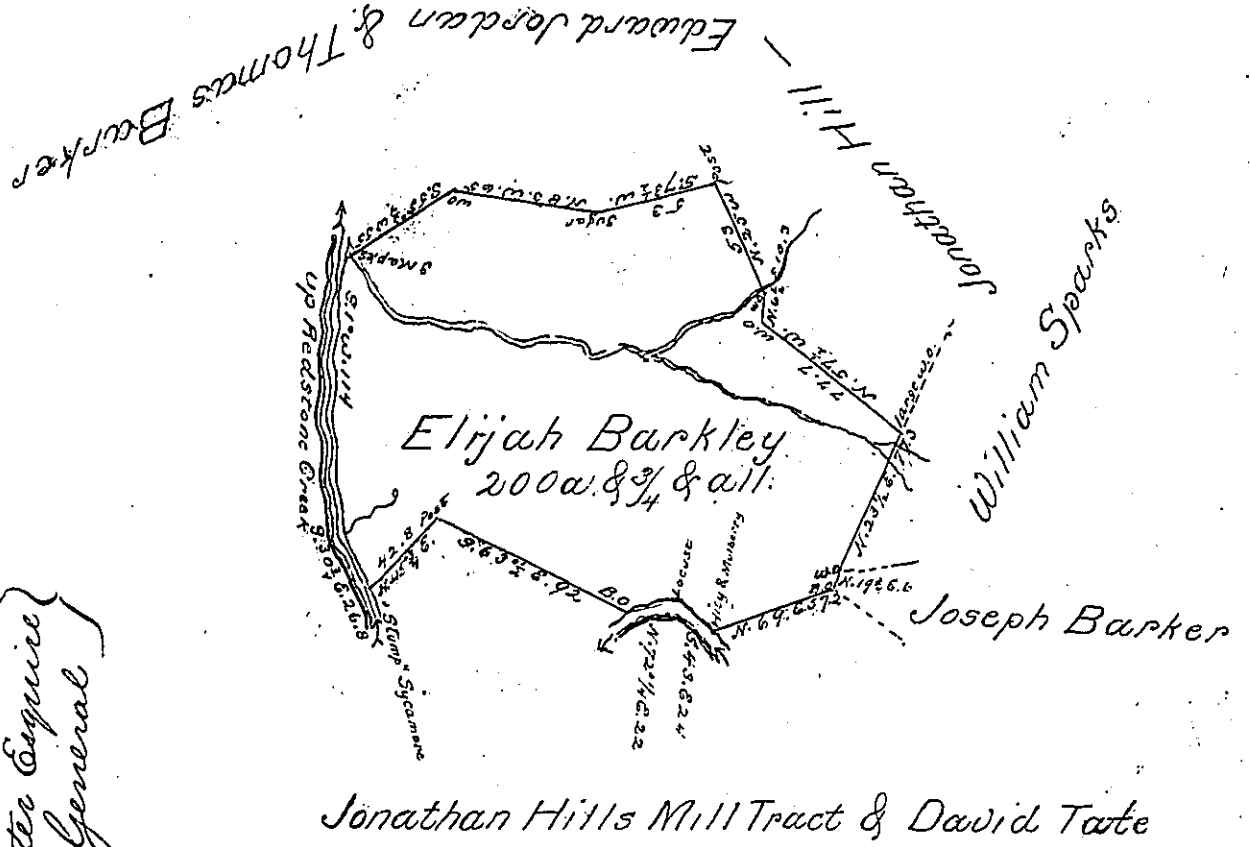

Situate on the North side of Big Redstone Creek in Franklin Township Fayette County & Surveyed Nov. 24th. 1786 In Pursuance of a Warrant dated the third day of Mayor June 1786

per Alexander McLean  
Deputy

To Andrew Porter Esqr.  
Surveyor General

copied from the original 9th Nov. 1810.

IN TESTIMONY that the above is a copy of the original remaining on file in the Department of Internal Affairs of Pennsylvania, made conformably to an Act of Assembly approved the 16th day of February, 1833, I have hereunto set my Hand and caused the Seal of said Department to be affixed at Harrisburg, this fifth day of December 1899

James W. Lewis  
Secretary of Internal Affairs.